

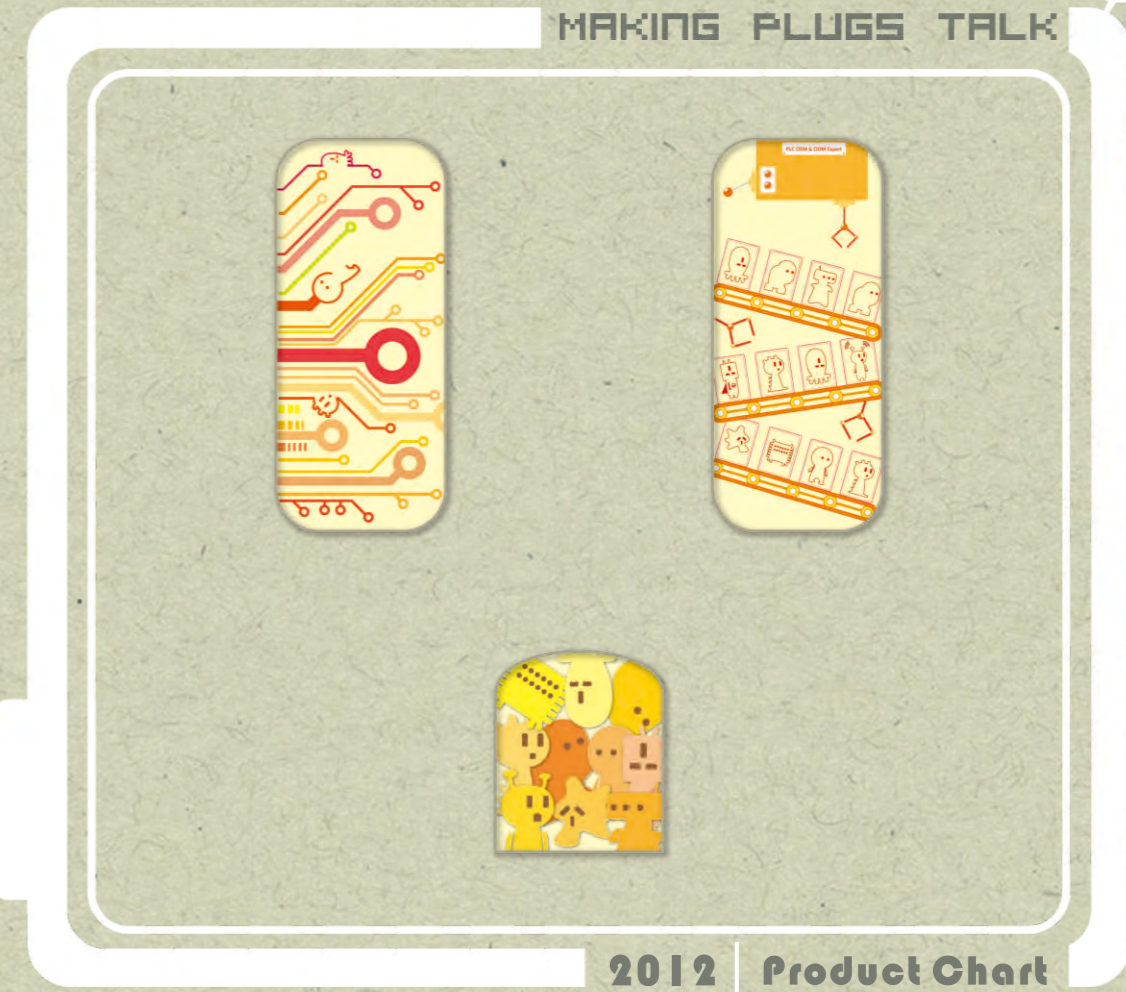

MAKING PLUGS TALK

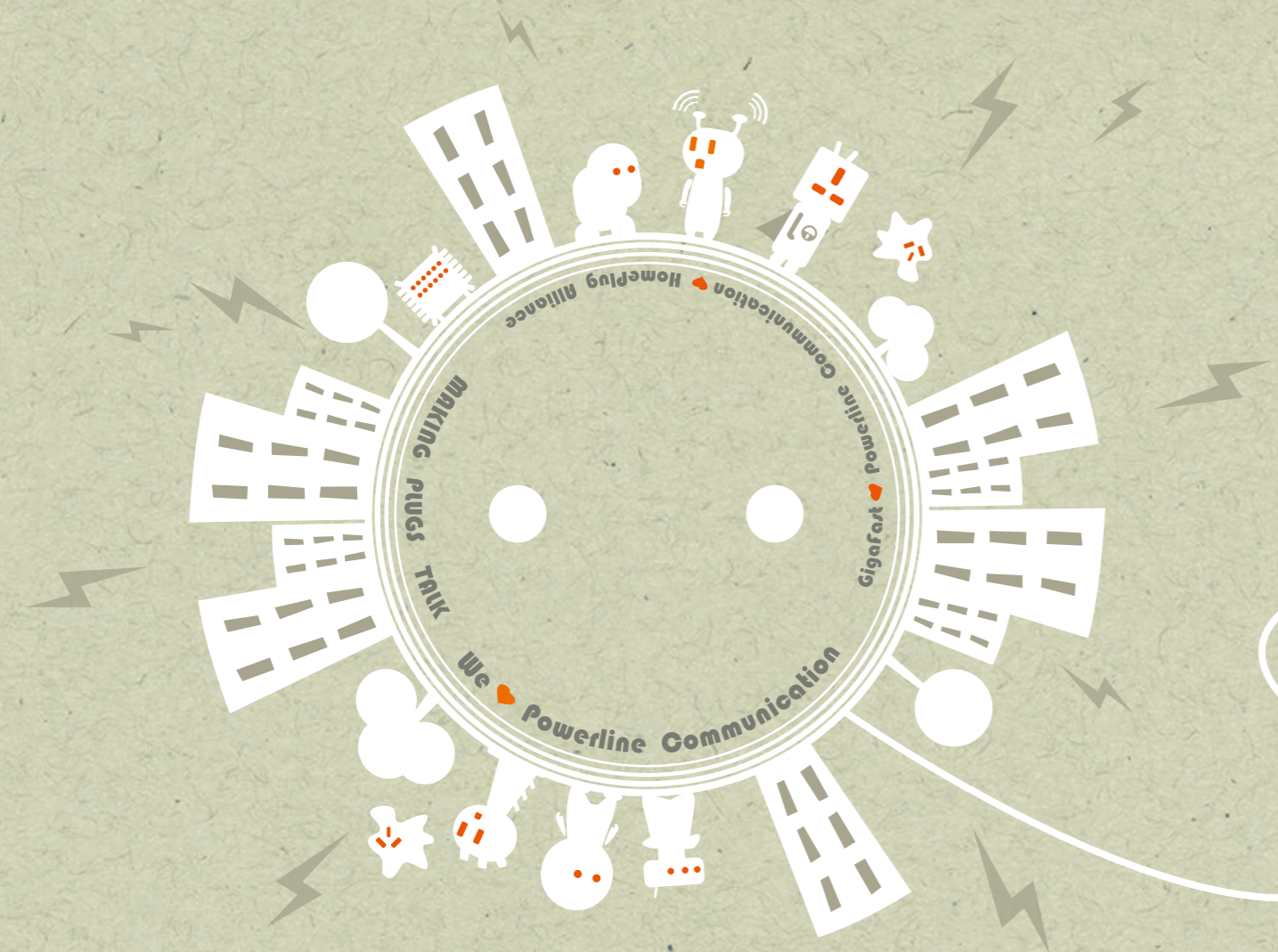

2012 | Product Chart



GigaFast E. Ltd. Taiwan Headquarter

捷辰科技股份有限公司

14F, No.112, Sec.1, Sintai 5th Road Sijhih District, New Taipei County, **Taiwan** 22102
台北縣汐止市新台五路一段112號12樓(東方科學園區A棟)
T: +886 2 2696 2852 / F: +886 2 2696 2850
www.gigafast.com

USA Branch

Sales and Marketing

2033 Gateway Place, Suite 500, San Jose, California, **USA**
T: +1 408 392 2333 / F: +1 408 904 6269
sales@gigafast.com / marketing@gigafast.com



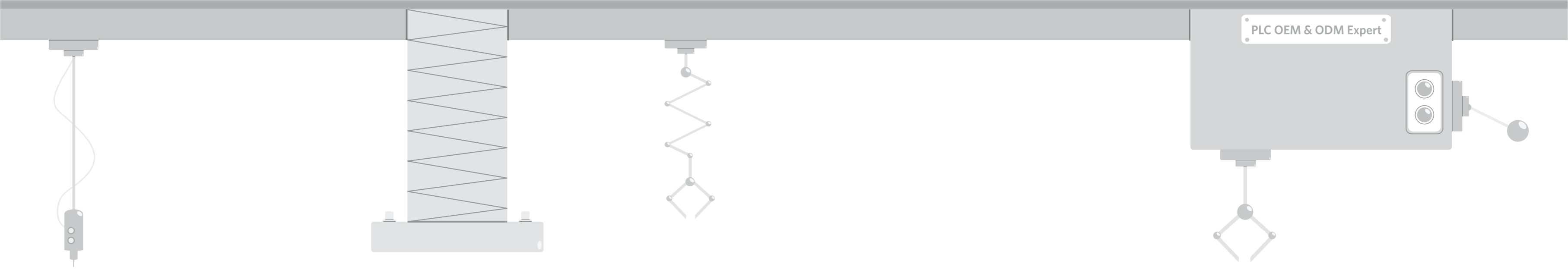

GigaFast is a OEM/ODM manufacturer, building Powerline products to clients' specifications. There are a number of methods for Powerline Communication. Of all the methods, we are a supporter of HomePlug Standards. Currently, all of our products are built to HomePlug Standards.

At GigaFast, we have been dedicating all of our efforts to develop and manufacture a complete line of top-quality Powerline Communication (PLC) products since 2001. Our strengths in R&D, manufacturing, and customer service have made GigaFast into a world leader in Powerline Communication OEM and ODM partner.

We believe it is about time consumers get spoiled with a technology as easy as plug and play, and eliminating the hassle of pulling wires. Compared to wireless network, PLC is much more secure and covers more distance.

After all, most consumer electronic devices already plug into power outlets, so why not make the existing wires and pugs do more than just providing power. Make the plugs talk, sing, view, and protect each other is what we do at GigaFast. Our complete line of PLC products can do all that through data, audio, video, and security applications.



We ♥ Powerline Communication

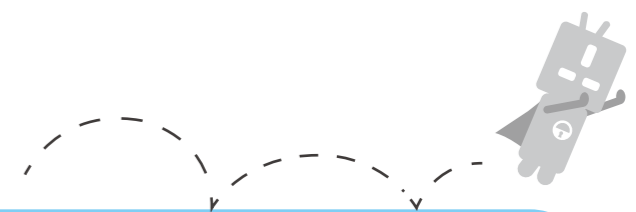

Gigafast ♥ Powerline Communication ♥ HomePlug Alliance

GigaFast Global OEM/ODM Team:

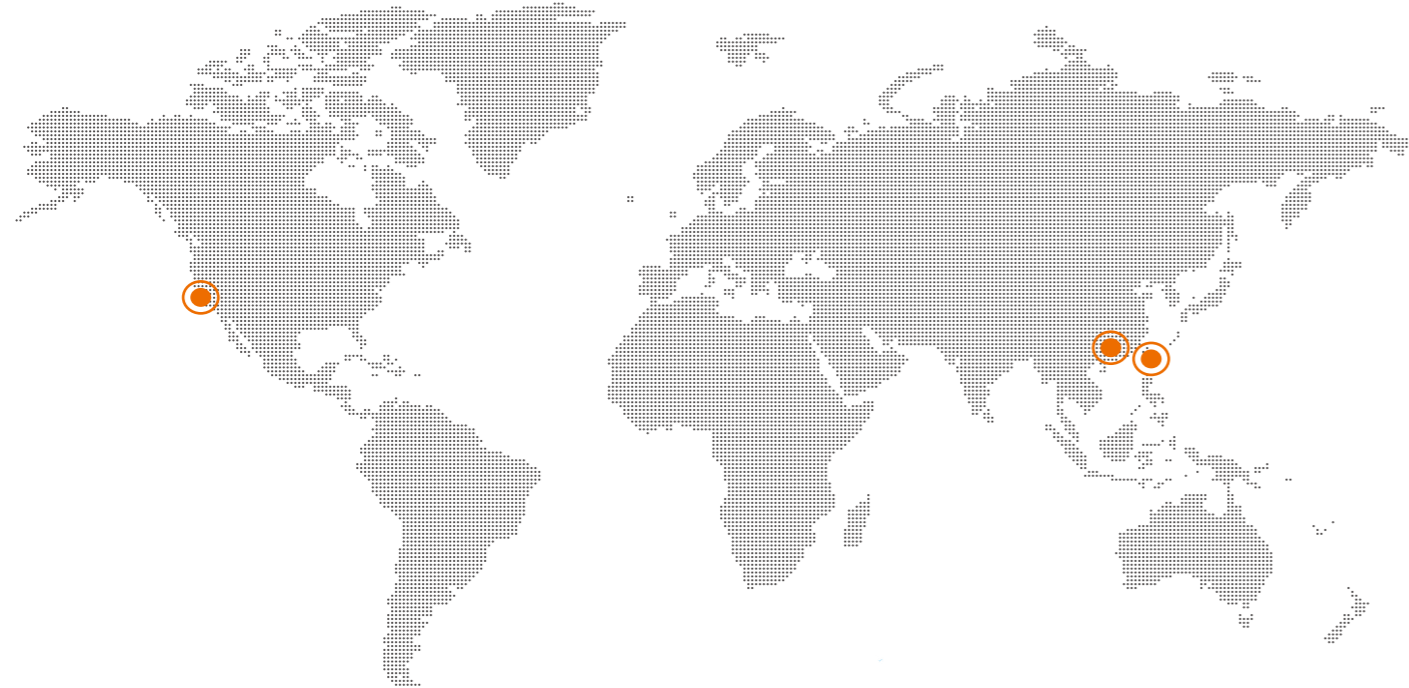

Founded in 1997 as a networking product manufacturing company, GigaFast provided innovative SOHO networking solutions enabling users to easily share Internet access, peripherals, and digital contents among multiple PC and Internet-enable devices.

Our engineering and customer service expertise in networking manufacturing helped tremendously when the company shifted its focus onto Powerline Communication in 2001.

With multiple offices worldwide, GigaFast is structured to provide customers with the maximum amount of marketing and technical support. In **Sijhih, Taiwan**, GigaFast houses its research development team while production and quality control is out of our factory in **Don Guan, China**. Our sales and marketing office is located in **San Jose, California**.

San Jose, USA Office
Business Development
Sales
Customer Service
Marketing



Don Guan, China Factory
Production
Assembly
Quality Control

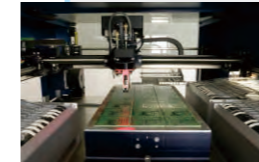

We Welcome Powerline Communication OEM/ODM Projects

Our current OEM/ODM partners consist of some of the world's most famous brands. We also have partners that are very promising start-up companies. GigaFast's strength is to provide a one-stop solution for all of our OEM/ODM partners and transform their ideas into innovative products.

With a dedicated engineering team, GigaFast has developed a wide range of product line covering multiple powerline communication applications.

Together with GigaFast's top-notch engineering team, a decade of manufacturing experience, and excellent customer service, GigaFast leads the industry in customizing powerline communication solutions for OEM and ODM clients.



Sijhih, Taiwan Headquarter
Research and Development
Product Design
Project Management
Customer Service
Production Management
Quality Control

GigaFast as OEM and ODM Expert on PLC



Introducing our newest and smallest **HomePlug AV 500Mbps nano Ethernet Bridge (PN958-EB2)**. This nano sized Ethernet bridge is currently the smallest 500Mbps bridge on the market! Inside this nano Bridge contains Qualcomm's newest AR7420 chipset which is optimized for high speed streaming of HD videos, playing online games, and download media files.

Introducing our newest and smallest **HomePlug AV 200Mbps nano Ethernet Bridge (PN928-EBg)**. This nano sized Ethernet bridge is currently the smallest bridge on the market! Inside this nano Bridge contains Broadcom's newest BCM60321 chipset which is a cost-effective and efficient solution to connect multiple devices and deliver multimedia content throughout the home.

Introducing our new **HomePlug AV 500Mbps nano Ethernet Bridge with Pass Through (PN959-EP2)**. This Ethernet bridge is the smallest 500Mbps pass-through bridge with a built-in noise filtering AC socket on the market! As a result, another device needing power can be plugged into the AC socket on this product without taking up another wall socket space.

Introducing our new **HomePlug AV 500Mbps mini Ethernet Bridge with Pass Through (PE959-EP)**. This Ethernet bridge comes with a built-in noise filtering AC socket. As a result, another device needing power can be plugged into the AC socket on this product without taking up another wall socket space.

HomePlug AV 500Mbps mini Ethernet Bridge (PS958-EB) uses Qualcomm's AR7400 chipset which is optimized for streaming HD videos, playing games, and download media files. It come with a Gigabit Ethernet port allowing for high performance wired connection along with the high speed powerline network.

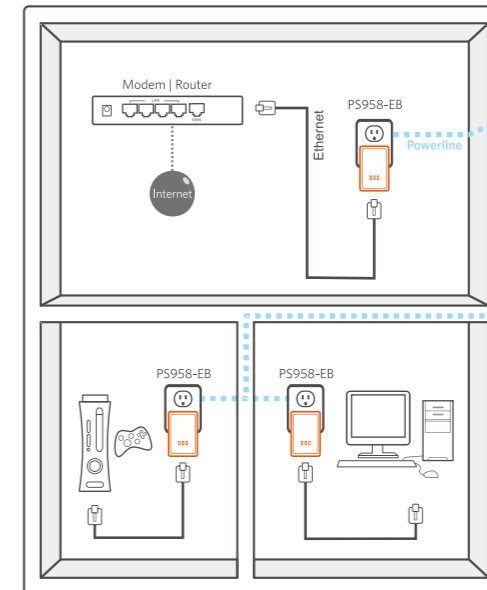
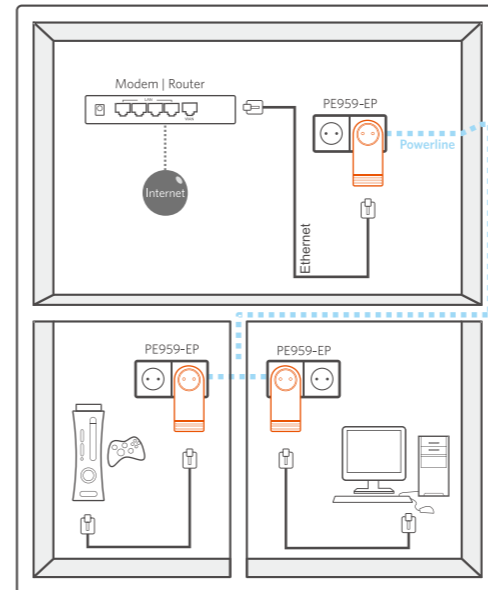
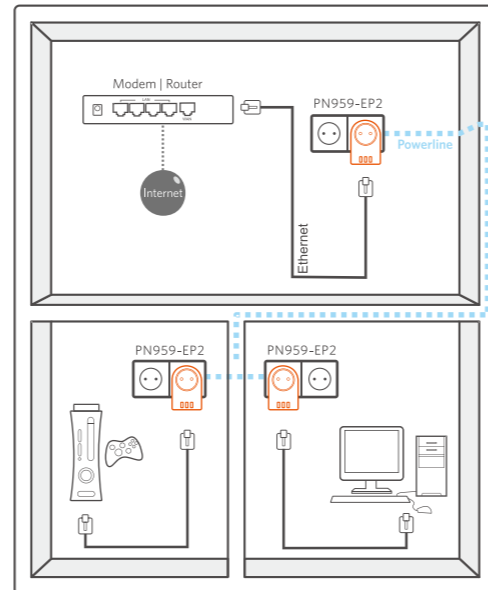
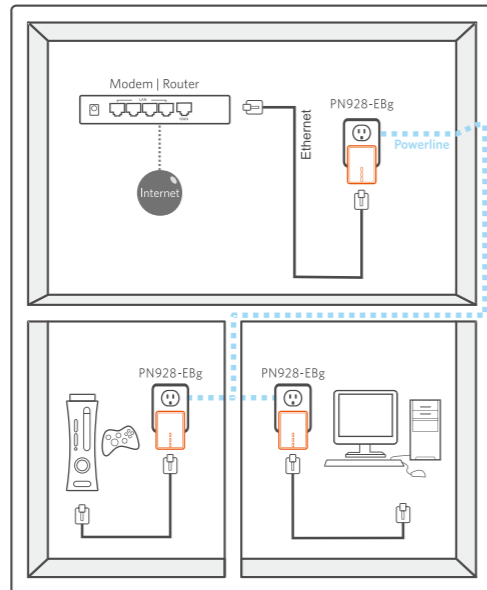
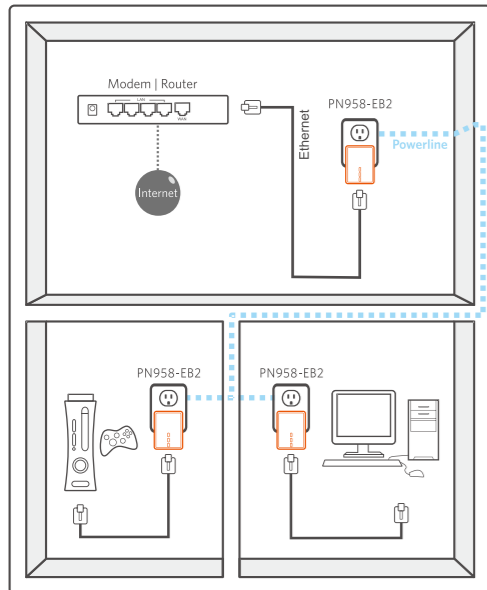

Featured Products



Product Types

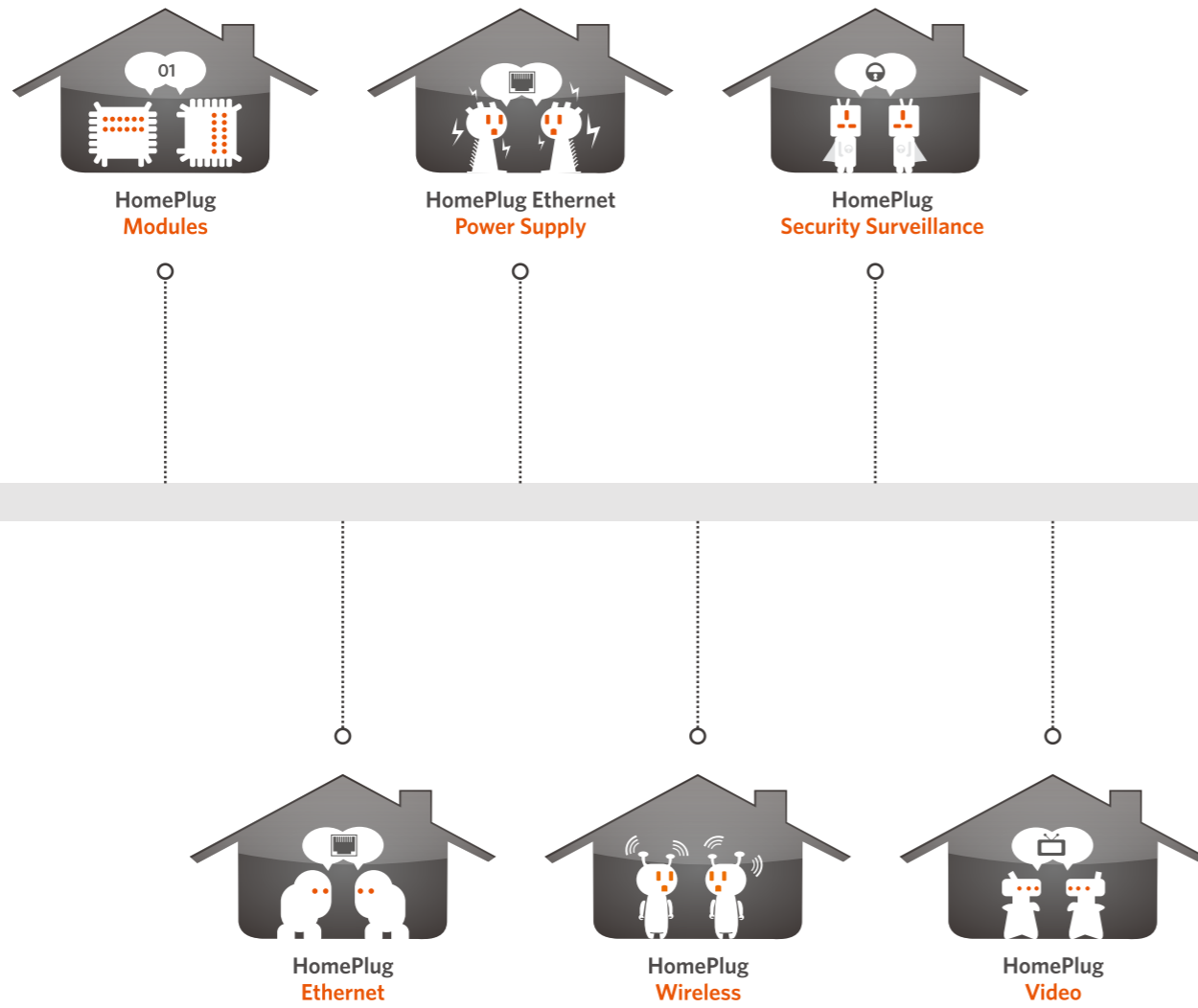

Your Awesome Product Here

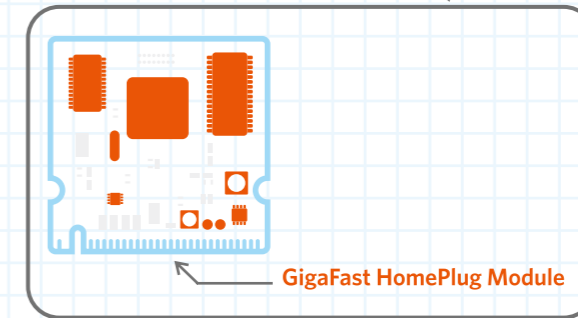

Sky is the limit!

If you can think it, we can help you integrate it into HomePlug!

GigaFast provides HomePlug modules for customers to easily integrate into products making them instantly HomePlug compliant. GigaFast HomePlug modules can be designed into your product with MII, mini PCI, or via standard Ethernet connectivity within the product itself. Advantages of going with ready-made modules from GigaFast include: quicker time to the market, minimum alteration to your product's original casing design, and extensive resources & knowledge GigaFast has about HomePlug technology and manufacturing.

GigaFast also provides engineering expertise to integrate these modules with your product, allowing it to easily migrate from a cable based solution into a HomePlug solution. With the widest choice in custom manufactured modules, GigaFast is the trusted partner that can offer module integration into any product that requires HomePlug connectivity.

HomePlug Modules



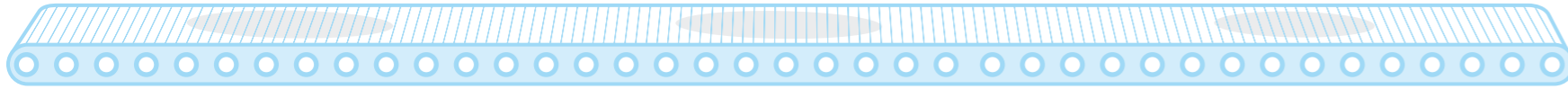
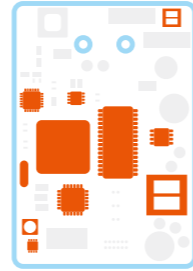
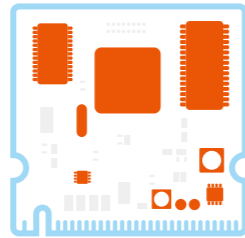
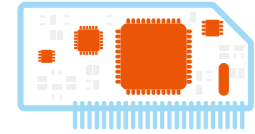
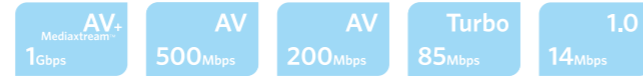
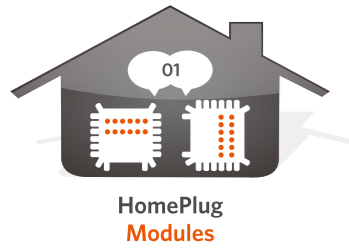

MII Module

- Available in any HomePlug chipset provider

Mini PCI Module

- Easy integration into devices with mini PCI slot

Power Module

- Ideal for devices that need both power and HomePlug

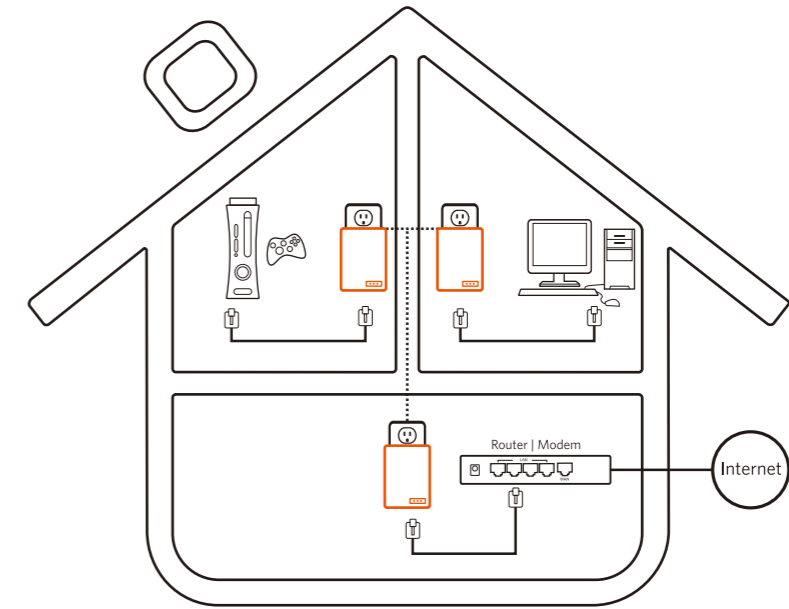

HomePlug Ethernet Bridge Usage Diagram

GigaFast HomePlug Ethernet products are plug and play and eliminate the need of pulling long Ethernet cables throughout the house. Our Ethernet bridges operate in 2 HomePlug standards: **HomePlug AV** and **HomePlug 1.0**. GigaFast is the market leader in developing and manufacturing HomePlug Ethernet bridges. With HomePlug Ethernet bridges performing up to 1 Gigabit per second, GigaFast offers the largest selection with the highest bandwidth HomePlug devices on the market.

Our HomePlug AV Ethernet bridges are **perfect for ultra-high speed HD entertainment networks** in homes as well as perfect for areas that are hard to reach by wireless connections. All of our HomePlug Ethernet bridges can be networked with network-comptatible entertainment systems, gaming consoles and home desktop/notebooks without any additional wiring while sharing Internet connections, printers, and files.

HomePlug Ethernet Bridges



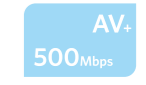

★ NEW ★



Wall-mount Ethernet Bridges	Model Number
○ AV 500Mbps nano Ethernet Bridge	PN958-EB2
○ AV 500Mbps mini Ethernet Bridge	PS958-EB2
○ AV 500Mbps Wireless N Access Point	PS957-EB2
○ AV 500Mbps nano Pass Through	PN958-EB2
○ AV 500Mbps Pass Through	PE959-EB2

PN958-EB2
AV 500Mbps nano Ethernet Bridge

- Qualcomm Atheros AR7420 chipset
- Ultra compact (64x46.5x24.5mm)
- Optimized for HD cable, satellite and IPTV installations, Home multimedia content and storage, multi-room DVR networking, online or networked console and PC video game connections, and much more
- Security push button for software free configuration
- 128-bit AES security
- CSMA/CA, TDMA
- QoS
- 2-50Mhz

PS958-EB2
AV 500Mbps mini Ethernet Bridge

- Qualcomm Atheros AR7420 chipset
- Extension to 68MHz spectrum and up to 500Mbps PHY rate
- Ultra compact (87x55x27mm)
- Optimized for HD/SD cable, satellite and IPTV installations, Home multimedia content and storage, multi-room DVR networking, online or networked console and PC video game connections, and much more
- Security push button for software free configuration
- 128-bit AES security
- CSMA/CA, TDMA
- QoS
- 2-50Mhz

PS837-AP2
AV 500Mbps Wireless N Access Point

- Qualcomm Atheros AR7420 chipset
- Create or extend a wireless network by using HomePlug Powerline technology as the network backbone
- Integrated and external antenna options
- Optimized for HD/SD cable, satellite and IPTV installations, Home multimedia content and storage, multi-room DVR networking, online/networked console and PC video game connections, and much more
- Compatible with 802.11n Draft 2.0 specifications providing wireless speed up to 300Mbps data rate. Also compatible with IEEE802.11g high rate standard providing wireless speed up to 54Mbps data rate
- WEP/WPA wireless security
- 128-bit AES security
- CSMA/CA, TDMA
- QoS
- 2-50Mhz

PN959-EP2
AV 500Mbps nano Pass Through

- Qualcomm Atheros AR7420 chipset
- Integrated pass through socket design so no electrical outlet is wasted
- Stand-alone unit attaches directly to broadband device and home powerline network for seamless integration
- Built-in filter of 2-50Mhz frequencies so the device plugged into the pass through will not interfere with existing powerline network
- Optimized for HD/SD cable, satellite and IPTV installations, Home multimedia content and storage, multi-room DVR networking, online or networked console and PC video game connections
- Type E + F Plug for EU application
- Type E Socket for EU application (240V / 10A)
- Security push button for software free configuration
- 128-bit AES security
- CSMA/CA, TDMA
- QoS
- 2-50Mhz

PE959-EP2
AV 500Mbps Pass Through

- Qualcomm Atheros AR7420 chipset
- Integrated pass through socket design so no electrical outlet is wasted
- Stand-alone unit attaches directly to broadband device and home powerline network for seamless integration
- Built-in filter of 2-30Mhz frequencies so the device plugged into the pass through will not interfere with existing powerline network
- Optimized for HD/SD cable, satellite and IPTV installations, Home multimedia content and storage, multi-room DVR networking, online or networked console and PC video game connections
- Type E + F Plug for EU application
- Type E Socket for EU application (240V / 10A)
- Security push button for software free configuration
- 128-bit AES security
- CSMA/CA, TDMA
- QoS
- 2-50Mhz

HomePlug AV+ Qualcomm AR7420

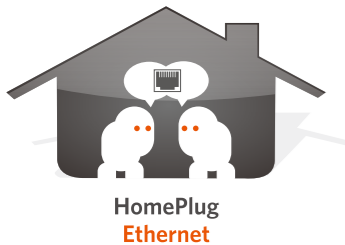

AV+
500Mbps

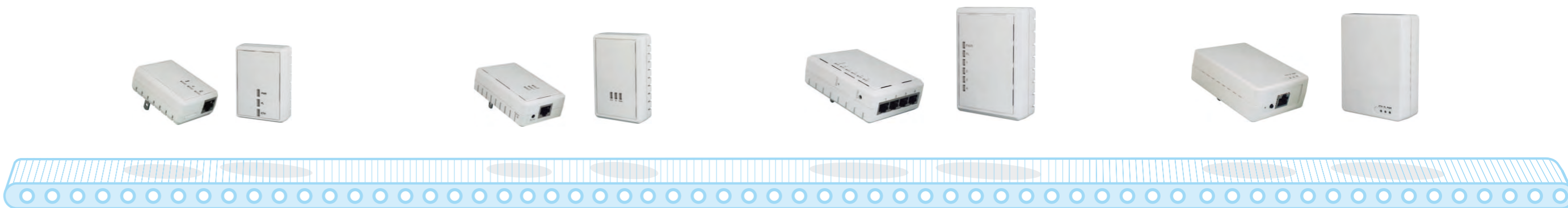

Wall-mount Ethernet Bridges	Model Number
○ AV 1-Port nano	PN958-EB
○ AV 1-Port mini	PS958-EB
○ AV 500Mbps 4-Port	PS957-EB
○ AV Gigabit 1-Port	PE938-EB
○ AV 1-Port mini	PE959-EB
○ AV 500Mbps 1-Port	PE958-EB

PN958-EB
AV 1-Port nano Wall-Mount

- Broadcom BCM60321
- Ultra compact (64x46.5x24.5mm)
- Optimized for HD/SD cable, satellite and IPTV installations, Home multimedia content and storage, multi-room DVR networking, online or networked console and PC video game connections, and much more
- Security push button for software free configuration
- 128-bit AES security
- CSMA/CA, TDMA
- QoS
- 2-28Mhz

PS958-EB
AV 1-Port mini Wall-Mount

- Qualcomm Atheros AR7400 chipset
- Extension to 68MHz spectrum and up to 500Mbps PHY rate
- Ultra compact (87x55x27mm)
- Optimized for HD/SD cable, satellite and IPTV installations, Home multimedia content and storage, multi-room DVR networking, online or networked console and PC video game connections, and much more
- Security push button for software free configuration
- 128-bit AES security
- CSMA/CA, TDMA
- QoS
- 2-50Mhz

PS957-EB
AV 500Mbps 4-Port Wall-Mount

- Qualcomm Atheros AR7400 chipset
- Extension to 68MHz spectrum and up to 500Mbps PHY rate
- IEEE1901 / HomePlug AV compliant
- 4 Gigabit Ethernet capability (IEEE 802.3ab, 1000BASE-T) for multiple close-by devices needing to connect onto the same powerline network
- Optimized for HD/SD cable, satellite and IPTV installations, Home multimedia content and storage, multi-room DVR networking, online/networked console and PC video game connections, and much more
- Security push button for software free configuration
- 128-bit AES security
- CSMA/CA, TDMA
- QoS
- 2-50Mhz

PE938-EB
AV Gigabit 1-Port Wall-Mount

- Broadcom BCM60541 chipset
- Up to 1Gbps PHY rate
- Gigabit Ethernet capability (IEEE 802.3ab, 1000BASE-T)
- Optimized for HD/SD cable, satellite and IPTV installations, Home multimedia content and storage, multi-room DVR networking, online/networked console and PC video game connections, and much more
- Dual-band powerline interface: HomePlug AV band + mediastream™ band
- Xtendnet™ Mesh repeating technology improving overall network performance when additional device is connected
- Maintains high data throughput even under extreme noise
- Security push button for software free configuration
- 128-bit AES security
- CSMA/CA, TDMA
- QoS
- 2-28Mhz ; 50-300Mhz

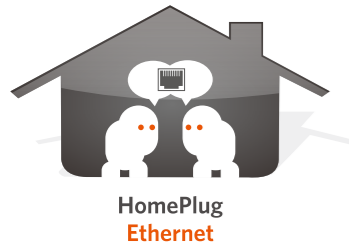

PE959-EB
AV 1-Port mini Wall-Mount

- Qualcomm Atheros AR7400 chipset
- Ultra compact wall design
- Optimized for HD/SD cable, satellite and IPTV installations, Home multimedia content and storage, multi-room DVR networking, online or networked console and PC video game connections, and much more
- Security push button for software free configuration
- 128-bit AES security
- CSMA/CA, TDMA
- QoS
- 2-50Mhz

PE958-EB
AV 500Mbps 1-Port Wall-Mount

- Qualcomm Atheros AR7400 chipset
- Extension to 68MHz spectrum and up to 500Mbps PHY rate
- IEEE1901 / HomePlug AV compliant
- Gigabit Ethernet capability (IEEE 802.3ab, 1000BASE-T)
- Optimized for streaming HD media applications and ultra-high speed HD entertainment networks
- Security push button for software free configuration
- 128-bit AES security
- CSMA/CA, TDMA
- QoS
- 2-50Mhz

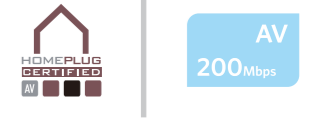

PN928-EBg
AV 1-Port nano Wall-Mount

- Broadcom BCM60321
- Ultra compact (64x46.5x24.5mm)
- Optimized for HD/SD cable, satellite and IPTV installations, Home multimedia content and storage, multi-room DVR networking, online or networked console and PC video game connections, and much more
- Security push button for software free configuration
- 128-bit AES security
- CSMA/CA, TDMA
- QoS
- 2-28Mhz

Wall-mount Ethernet Bridges	Model Number
○ AV 1-Port nano	PN928-EBg
○ AV 1-Port mini	PS928-EB
○ AV 1-Port mini	PS928-EBg
○ AV 4-Port	PS927-EB
○ AV 1-Port mini	PE929-EB
○ AV 1-Port	PL928-EB
○ AV 1-Port	PL928-EBg
○ AV 1-Port	PE928-EB
○ AV 1-Port	PE928-EBs
○ AV 3-Port	PG928-EBs
Desktop Ethernet Bridges	
○ AV 1-Port	PE922-EB
○ AV 4-Port	PE923-EB
Specialty Ethernet Bridges	
○ AV Coax and Powerline Hybrid	PE924-HB

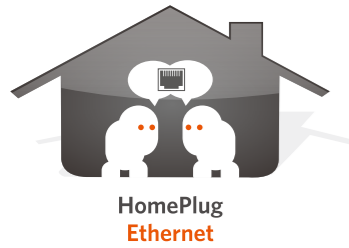

AV
200Mbps



PS928-EB
AV 1-Port mini Wall-Mount

- Qualcomm Atheros AR6400 or AR6405 chipset
- Ultra compact (87x55x27mm)
- Optimized for HD/SD cable, satellite and IPTV installations, Home multimedia content and storage, multi-room DVR networking, online or networked console and PC video game connections, and much more
- Security push button for software free configuration
- 128-bit AES security
- CSMA/CA, TDMA
- QoS
- 2-28Mhz

PS928-EBg
AV 1-Port mini Wall-Mount

- Broadcom BCM60301 chipset
- Ultra compact (87x55x27mm)
- Optimized for HD/SD cable, satellite and IPTV installations, Home multimedia content and storage, multi-room DVR networking, online or networked console and PC video game connections, and much more
- Security push button for software free configuration
- 128-bit AES security
- CSMA/CA, TDMA
- QoS
- 2-28Mhz

PS927-EB
AV 4-Port Wall-Mount

- Qualcomm Atheros AR6400 or AR6405 chipset
- 4 Ethernet ports for multiple close-by devices needing to connect onto the same powerline network
- Optimized for HD/SD cable, satellite and IPTV installations, Home multimedia content and storage, multi-room DVR networking, online/networked console and PC video game connections, and much more
- Security push button for software free configuration
- 128-bit AES security
- CSMA/CA, TDMA
- QoS
- 2-28Mhz

PE929-EB
AV 1-Port mini Wall-Mount

- Qualcomm Atheros AR6400 or AR6405 chipset
- Ultra compact wall design
- Optimized for HD/SD cable, satellite and IPTV installations, Home multimedia content and storage, multi-room DVR networking, online or networked console and PC video game connections, and much more
- Security push button for software free configuration
- 128-bit AES security
- CSMA/CA, TDMA
- QoS
- 2-28Mhz

PL928-EB
AV 1-Port Wall-Mount

- Qualcomm Atheros AR6400 or AR6405 chipset
- Optimized for HD/SD cable, satellite and IPTV installations, Home multimedia content and storage, multi-room DVR networking, online or networked console and PC video game connections, and much more
- Security push button for software free configuration
- 128-bit AES security
- CSMA/CA, TDMA
- QoS
- 2-28Mhz

PL928-EBg
AV 1-Port Wall-Mount

- Broadcom BCM60301 chipset
- Optimized for HD/SD cable, satellite and IPTV installations, Home multimedia content and storage, multi-room DVR networking, online or networked console and PC video game connections, and much more
- Security push button for software free configuration
- 128-bit AES security
- CSMA/CA, TDMA
- QoS
- 2-28Mhz

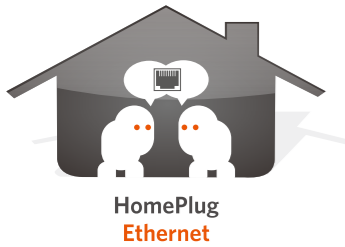

AV
200Mbps



PE928-EB
AV 1-Port Wall-Mount

- Qualcomm Atheros AR6400 or AR6405 chipset
- Optimized for HD/SD cable, satellite and IPTV installations, Home multimedia content and storage, multi-room DVR networking, online/networked console and PC video game connections, and much more
- Security push button for software free configuration
- 128-bit AES security
- CSMA/CA, TDMA
- QoS
- 2-28Mhz

PE928-EBs
AV 1-Port Wall-Mount

- Sigma CG2110 chipset
- Optimized for HD/SD cable, satellite and IPTV installations, Home multimedia content and storage, multi-room DVR networking, online/networked console and PC video game connections, and much more
- Security push button for software free configuration
- 128-bit AES security
- CSMA/CA, TDMA
- QoS
- 2-28Mhz

PG928-EBs
AV 1-Port Wall-Mount

- Sigma CG2110 chipset
- Clearpath uses phase neutral, and ground for improved signal coverage
- Optimized for HD/SD cable, satellite and IPTV installations, Home multimedia content and storage, multi-room DVR networking, online/networked console and PC video game connections, and much more
- Security push button for software free configuration
- 128-bit AES security
- CSMA/CA, TDMA
- QoS
- 2-28Mhz

PE922-EB
AV 1-Port Desktop

- Qualcomm Atheros AR6400 or AR6405 chipset
- Power cable allows use for multiple countries
- Optimized for HD/SD cable, satellite and IPTV installations, Home multimedia content and storage, multi-room DVR networking, online/networked console and PC video game connections, and much more
- Security push button for software free configuration
- 128-bit AES security
- CSMA/CA, TDMA
- QoS
- 2-28Mhz

PE923-EB
AV 4-Port Desktop

- Qualcomm Atheros AR6400 or AR6405 chipset
- Power cable allows use for multiple countries
- 4 Ethernet ports for multiple close-by devices needing to connect onto the same powerline network
- Optimized for HD/SD cable, satellite and IPTV installations, Home multimedia content and storage, multi-room DVR networking, online/networked console and PC video game connections, and much more
- Security push button for software free configuration
- 128-bit AES Security
- CSMA/CA, TDMA
- QoS
- 2-28Mhz

PE924-HB
AV Coax and Powerline Hybrid

- Qualcomm Atheros AR6400 or AR6405 chipset
- Customizable faceplate
- Coax and Powerline option switch button
- Power cable allows use for multiple countries
- Optimized for HD/SD cable, satellite and IPTV installations, Home multimedia content and storage, multi-room DVR networking, online/networked console and PC video game connections, and much more
- Security push button for software free configuration
- 128-bit AES security
- CSMA/CA, TDMA
- QoS
- 2-28Mhz

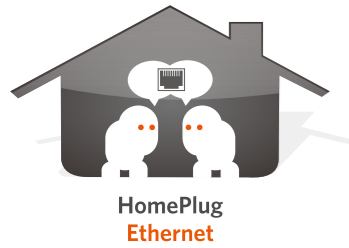

Turbo
85Mbps

Wall-mount Ethernet Bridges	Model Number
○ Turbo 1-Port mini	PE919-EB
○ Turbo 1-Port	PE918-EB
○ Turbo 3-Port	PE917-EB
Desktop Ethernet Bridges	
○ Turbo 1-Port	PE912-EB
○ Turbo 4-Port	PE913-EB



PE919-EB
Turbo 1-Port mini Wall-Mount

- Qualcomm Atheros INT5500
- Ultra Compact Wall design
- Optimized for standard definition (SD) video distribution, TV over IP (IPTV), digital video recorder (DVR) networking and media center PCs, Voice Over IP calls, PC file and application sharing, printer and peripheral sharing, networking and online gaming, security cameras and much more
- 56-bit DES security
- CSMA/CA
- QoS
- 4-21Mhz

PE918-EB
Turbo 1-Port Wall-Mount

- Qualcomm Atheros INT5500 chipset
- Optimized for standard definition (SD) video distribution, TV over IP (IPTV), digital video recorder (DVR) networking and media center PCs, Voice Over IP calls, PC file and application sharing, printer and peripheral sharing, networking and online gaming, security cameras and much more
- 56-bit DES security
- CSMA/CA
- QoS
- 4-21Mhz

PE917-EB
Turbo 3-Port Wall Mount

- Qualcomm Atheros INT5500 chipset
- 3 Ethernet ports for multiple close-by devices needing to connect onto the same powerline network
- Optimized for standard definition (SD) video distribution, TV over IP (IPTV), digital video recorder (DVR) networking and media center PCs, Voice Over IP calls, PC file and application sharing, printer and peripheral sharing, networking and online gaming, security cameras and much more
- 56-bit DES security
- CSMA/CA
- QoS
- 4-21Mhz

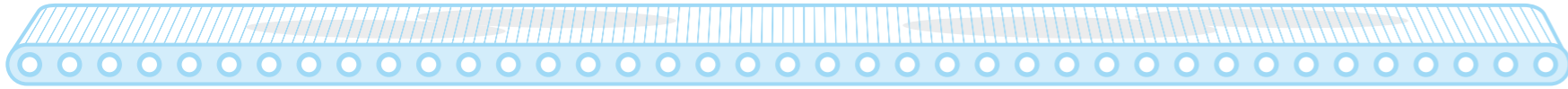
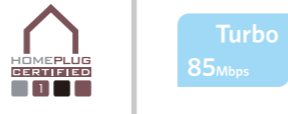
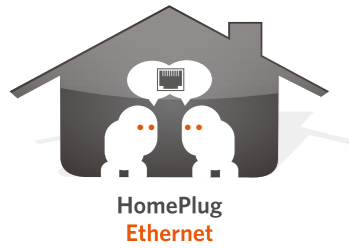

PE912-EB

Turbo 1-Port Desktop

- Qualcomm Atheros INT5500 chipset
- Power Cable allows use for multiple countries
- Optimized for standard definition (SD) video distribution, TV over IP (IPTV), digital video recorder (DVR) networking and media center PCs, Voice Over IP calls, PC file and application sharing, printer and peripheral sharing, networking and online gaming, security cameras and much more
- 56-bit DES security
- CSMA/CA
- QoS
- 4-21Mhz

PE913-EB

Turbo 4-Port Desktop

- Qualcomm Atheros INT5500 chipset
- Power cable allows use for multiple countries
- 4 Ethernet ports for multiple close-by devices needing to connect onto the same powerline network
- Optimized for standard definition (SD) video distribution, TV over IP (IPTV), digital video recorder (DVR) networking and media center PCs, Voice Over IP calls, PC file and application sharing, printer and peripheral sharing, networking and online gaming, security cameras and much more
- 56-bit DES security
- CSMA/CA
- QoS
- 4-21Mhz

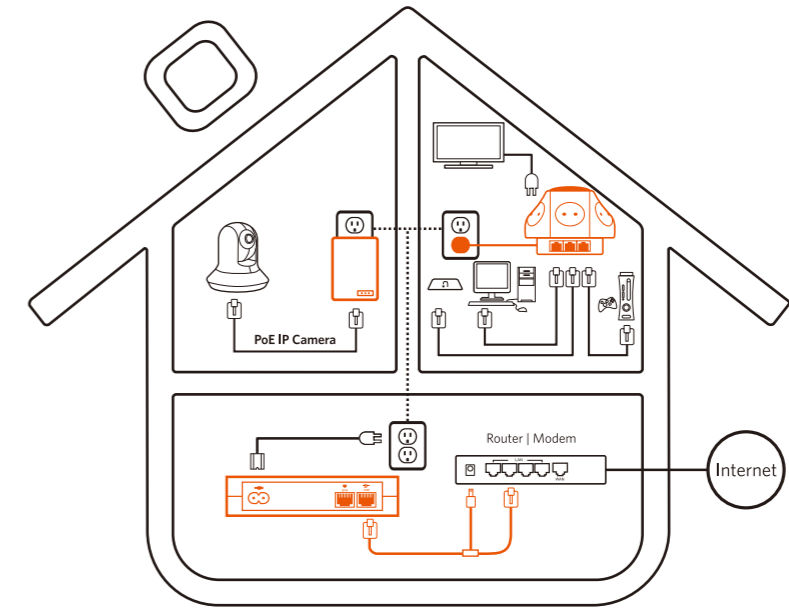

HomePlug Ethernet Power Supply Usage Diagram

GigaFast HomePlug Ethernet Power Supply products can turn Ethernet devices such as set-top boxes and routers into HomePlug products. At the same time, our HomePlug Ethernet power supply products provide electrical power to those Ethernet devices. The HomePlug Ethernet Power Supply comes with a Y-Cable so the device receives DC power and Ethernet signal without wasting an extra electrical outlet.

HomePlug Power over Ethernet (PoE) products can power any PoE enabled devices and at the same time provide HomePlug signal with just a Ethernet cable . All of our HomePlug PoE products work with IEEE802.3af-enabled devices such as IP cameras, VoIP, wireless access points, routers, etc.

Our HomePlug Pass Through and Power Strip products are also part of the Ethernet power supply category. These products not only provide HomePlug network to Ethernet devices, they also give back a socket or sockets for you to plug other devices into.

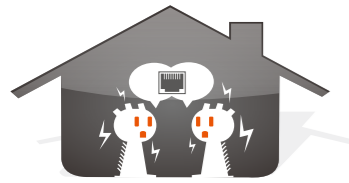

HomePlug Ethernet
Power Supply



AV
500Mbps



AV
200Mbps

Wall-mount Pass Through

- AV 500Mbps Pass Through
- AV mini Pass Through
- AV Pass Through
- AV Pass Through
- AV 4-Port Pass Through

Model Number

- PE959-EP
- PN929-EP
- PE929-EP
- PE929-EPg
- PE923-EP

Desktop Ethernet Power Supply

- AV 36-Watt Ethernet Power Supply
- AV 36-Watt Ethernet Power Supply
- AV 30-Watt Ethernet Power Supply

- PE929-PLA
- PE929-PLAg
- PE926-PLA

Wall-mount Ethernet Power Supply

- AV 6-Watt Ethernet Power Supply

- PE925-PLA

Wall-mount Power over Ethernet

- AV Power over Ethernet

- PE925-PoE

Desktop Power over Ethernet

- AV Power over Ethernet

- PE926-PoE

Power Strip with Ethernet Ports

- AV 6-Outlet Power Strip with 3 Ethernet Ports

- PE927-UPS



PE959-EP

AV 500Mbps Pass Through

- Qualcomm Atheros AR7400 chipset
- Integrated pass through socket design so no electrical outlet is wasted
- Stand-alone unit attaches directly to broadband device and home powerline network for seamless integration
- Built-in filter of 2-50Mhz frequencies so the device plugged into the pass through will not interfere with existing powerline network
- Optimized for HD/SD cable, satellite and IPTV installations, Home multimedia content and storage, multi-room DVR networking, online or networked console and PC video game connections
- Type E + F Plug for EU application
- Type E Socket for EU application (240V / 10A)
- Security push button for software free configuration
- 128-bit AES security
- CSMA/CA, TDMA
- QoS
- 2-50Mhz

PN929-EP

AV mini Pass Through

- Qualcomm Atheros AR6400 or AR6405 chipset
- Integrated pass through socket design so no electrical outlet is wasted
- Stand-alone unit attaches directly to broadband device and home powerline network for seamless integration
- Built-in filter of 2-30Mhz frequencies so the device plugged into the pass through will not interfere with existing powerline network
- Optimized for HD/SD cable, satellite and IPTV installations, Home multimedia content and storage, multi-room DVR networking, online or networked console and PC video game connections
- Type E + F Plug for EU application
- Type E Socket for EU application (240V / 10A)
- Security push button for software free configuration
- 128-bit AES security
- CSMA/CA, TDMA
- QoS
- 2-28Mhz

PE929-EP

AV Pass Through

- Qualcomm Atheros AR6400 or AR6405 chipset
- Integrated pass through socket design so no electrical outlet is wasted
- Stand-alone unit attaches directly to broadband device and home powerline network for seamless integration
- Built-in filter of 2-30Mhz frequencies so the device plugged into the pass through will not interfere with existing powerline network
- Optimized for HD/SD cable, satellite and IPTV installations, Home multimedia content and storage, multi-room DVR networking, online or networked console and PC video game connections
- Type E + F Plug for EU application
- Type E Socket for EU application (240V / 10A)
- Security push button for software free configuration
- 128-bit AES security
- CSMA/CA, TDMA
- QoS
- 2-28Mhz

PE929-EPg

AV Pass Through

- Broadcom BCM60301 chipset
- Integrated pass through socket design so no electrical outlet is wasted
- Stand-alone unit attaches directly to broadband device and home powerline network for seamless integration
- Built-in filter of 2-30Mhz frequencies so the device plugged into the pass through will not interfere with existing powerline network
- Optimized for HD/SD cable, satellite and IPTV installations, Home multimedia content and storage, multi-room DVR networking, online or networked console and PC video game connections
- Type E + F Plug for EU application
- Type E Socket for EU application (240V / 10A)
- Security push button for software free configuration
- 128-bit AES security
- CSMA/CA, TDMA
- QoS
- 2-28Mhz

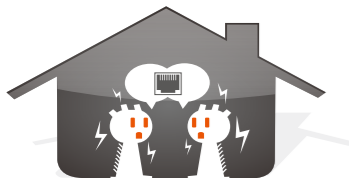

HomePlug Ethernet
Power Supply



AV
200Mbps



PE923-EP

AV 4-Port Pass Through

- Qualcomm Atheros AR6400 or AR6405 chipset
- Integrated pass through socket design so no electrical outlet is wasted
- 4 Ethernet ports for multiple close-by devices needing to connect onto the same powerline network
- Built-in filter of 2-30Mhz frequencies so the device plugged into the pass through will not interfere with existing powerline network
- Type E + F Plug for EU application
- Type E Socket for EU application (240V / 10A)
- Security push button for software free configuration
- 128-bit AES security
- CSMA/CA, TDMA
- QoS
- 2-28Mhz

PE929-PLA

AV 36-Watt Ethernet Power Supply

- Qualcomm Atheros AR6400 or AR6405 chipset
- Customizable faceplate
- Optimized for HD/SD cable, satellite and IPTV installations, Home multimedia content and storage, multi-room DVR networking, online or networked console and PC video game connections
- Include Y-Cable to provide both data and power
- 5V, 12V, 19V power output levels
- Security push button for software free configuration
- 128-bit AES security
- CSMA/CA, TDMA
- QoS
- 2-28Mhz

PE929-PLAg

AV 36-Watt Ethernet Power Supply

- Broadcom BCM60301 chipset
- Customizable faceplate
- Optimized for HD/SD cable, satellite and IPTV installations, Home multimedia content and storage, multi-room DVR networking, online or networked console and PC video game connections
- Include Y-Cable to provide both data and power
- 5V, 12V, 19V power output levels
- Security push button for software free configuration
- 128-bit AES security
- CSMA/CA, TDMA
- QoS
- 2-28Mhz

PE926-PLA

AV 30-Watt Ethernet Power Supply

- Qualcomm Atheros AR6400 or AR6405 chipset
- Customizable faceplate
- Optimized for HD/SD cable, satellite and IPTV installations, Home multimedia content and storage, multi-room DVR networking, online or networked console and PC video game connections
- Include Y-Cable to provide both data and power
- 5V, 12V, 19V power output levels
- Security push button for software free configuration
- 128-bit AES security
- CSMA/CA, TDMA
- QoS
- 2-28Mhz

PE925-PLA

AV 6-Watt Ethernet Power Supply

- Qualcomm Atheros AR6400 or AR6405 chipset
- Optimized for HD/SD cable, satellite and IPTV installations, Home multimedia content and storage, multi-room DVR networking, online or networked console and PC video game connections
- Include Y-Cable to provide both data and power
- 5V / 1A, 12V / 0.5A power output levels
- Security push button for software free configuration
- 128-bit AES security
- CSMA/CA, TDMA
- QoS
- 2-28Mhz

PE925-PoE

AV Wall-Mount Power over Ethernet

- Qualcomm Atheros AR6400 or AR6405 chipset
- Supply DC power to a PoE enabled device with only a RJ45 Ethernet cable
- Optimized to power any PoE enabled device such as: IP cameras, set-top boxes, modem, router, or access point, eliminating the need for an additional power supply
- 1-Port support 48V DC power to PoE powered device
- End-point insert type and compatible with IEEE802.3af
- Per port feeding power: 7 watt (Class II)
- Security push button for software free configuration
- 128-bit AES security
- CSMA/CA, TDMA
- QoS
- 2-28Mhz

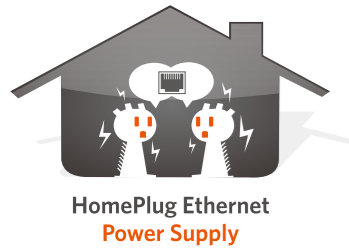

AV
200Mbps

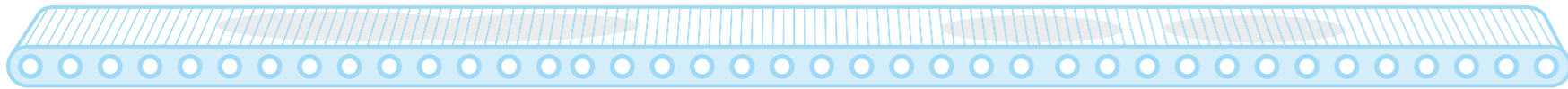

PE926-PoE
AV Desktop Power over Ethernet

- Qualcomm Atheros AR6400 or AR6405 chipset
- Supply DC power to a PoE enabled device with only a RJ45 Ethernet cable
- Optimized to power any PoE enabled device such as: IP camera, set-top box, modem, router, or access point, eliminating the need for an additional power supply
- 1-Port support 48V DC power to PoE powered device
- End-point insert type and compatible with IEEE802.3af
- Per port feeding power: 15.4 watts
- Security push button for software free configuration
- 128-bit AES security
- CSMA/CA, TDMA
- QoS
- 2-28Mhz

PE927-UPS
AV 6-Outlet Power Strip with 3 Ethernet Ports

- Qualcomm Atheros AR6400 or AR6405 chipset
- Designed for both desktop and floor use
- Smart form follows function design--every outlet can be plugged-in at the same time without blocking each other
- 3 Ethernet ports for multiple close-by devices needing to connect onto the same powerline network
- Optimized for HD/SD cable, satellite and IPTV installations, Home multimedia content and storage, multi-room DVR networking, online or networked console and PC video game connection
- US/EU/UK/AU plug types available
- 6 full-3-line surge protector (3MOV) with filtered power outlets and children safety shutters
- Security push button for software free configuration
- 128-bit AES security
- CSMA/CA, TDMA
- QoS
- 2-28Mhz



Turbo
85Mbps

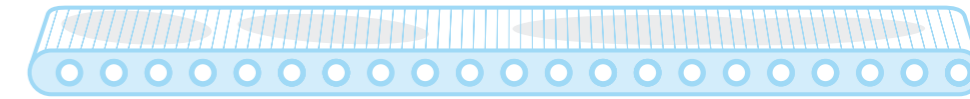

Wall-mount Ethernet Power Supply **Model Number**

○ AV 6-Watt Ethernet Power Supply PE915-PLA

○ Turbo 30-Watt Ethernet Power Supply PE916-PLA

Wall-mount Power over Ethernet

○ Turbo Power over Ethernet PE915-PoE

Desktop Power over Ethernet

○ Turbo Power over Ethernet PE916-PoE

Power Strip with Ethernet Ports

○ Turbo 6-Outlet Power Strip with 3 Ethernet Ports PE917-UPS

PE915-PLA
Turbo 6-Watt Ethernet Power Supply

- Qualcomm Atheros INT5500 chipset (2nd generation)
- Optimized for standard definition (SD) video distribution, TV over IP (IPTV), digital video recorder (DVR) networking and media center PCs, Voice Over IP calls, PC file and application sharing, printer and peripheral sharing, networking and online gaming, security cameras and much more
- Include Y-Cable to provide both data and power
- 5V / 1A, 12V / 0.5A power output levels
- 56-bit DES security
- CSMA/CA, TDMA
- QoS
- 4-21Mhz

PE916-PLA
Turbo 30-Watt Ethernet Power Supply

- Qualcomm Atheros INT5500 chipset (2nd generation)
- Optimized for standard definition (SD) video distribution, TV over IP (IPTV), digital video recorder (DVR) networking and media center PCs, Voice Over IP calls, PC file and application sharing, printer and peripheral sharing, networking and online gaming, security cameras and much more
- Include Y-Cable to provide both data and power
- 5V, 12V, 19V power output levels
- 56-bit DES security
- CSMA/CA, TDMA
- QoS
- 4-21Mhz

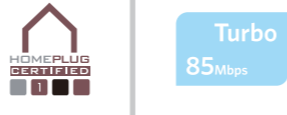
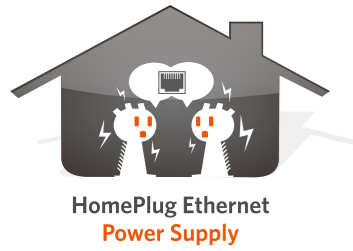

PE915-PoE

Turbo Wall-Mount Power over Ethernet

- Qualcomm Atheros INT5500 chipset
- Supply DC power to a PoE enabled device with only a RJ45 Ethernet cable
- Optimized to power any PoE enabled device such as: IP cameras, set-top boxes, modem, router, or access point, eliminating the need for an additional power supply
- 1-Port support 48V DC power to PoE powered device
- End-point insert type and compatible with IEEE802.3af
- Per port feeding power: 7 watts (Class II)
- Clean application
- 56-bit DES security
- CSMA/CA, TDMA
- QoS
- 4-21Mhz

PE916-PoE

Turbo Desktop Power over Ethernet

- Qualcomm Atheros INT5500 chipset
- Supply DC power to a PoE enabled device with only a RJ45 Ethernet cable
- Optimized to power any PoE enabled device such as: IP camera, set-top box, modem, router, or access point, eliminating the need for an additional power supply
- 1-Port support 48V DC power to PoE powered device
- End-point insert type and compatible with IEEE802.3af
- Per port feeding power: 15.4 watts
- Clean application
- 56-bit DES security
- CSMA/CA, TDMA
- QoS
- 4-21Mhz

PE917-UPS

Turbo 6-Outlet Power Strip with 3 Ethernet Ports

- Qualcomm Athros INT5500 chipset
- Designed for both desktop and floor use
- Smart form follows function design--every outlet can be plugged-in at the same time without blocking each other
- 3 Ethernet ports for multiple close-by devices needing to connect onto the same powerline network
- Optimized for HD/SD cable, satellite and IPTV installations, Home multimedia content and storage, multi-room DVR networking, on-line or networked console and PC video game connection
- US/EU/UK/AU plug types available
- 6 full-3-line surge protector (3MOV) with filtered power outlets and children safety shutters
- 56-bit DES security
- CSMA/CA, TDMA
- QoS
- 4-21Mhz

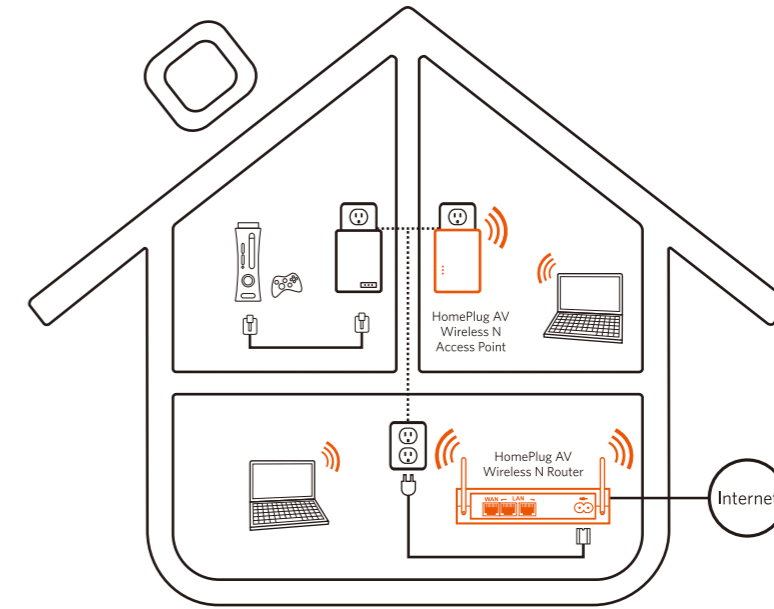

HomePlug Wireless Usage Diagram

Today's households demand high quality media entertainment center with HD quality LCD or plasma TV, IPTV Set-top box, Internet, gaming consoles, media server, etc. GigaFast's HomePlug Wireless products are the perfect solution for that demand by turning the entire house including all electrical plugs in the house into a home network.

The HomePlug AV Wireless N Router has the best of the networking world with 3 different connectivity options: HomePlug, Wireless, and Ethernet.

Another great HomePlug Wireless product is the HomePlug Turbo Wireless Access Point. It uses HomePlug networking as a backbone to extend the coverage of your wireless network. By plugging one of these HomePlug Access Points into an area with weak wireless signal, your wireless signal is instantly boosted. Connectivity to your mobile device is made from Wireless through the power lines to the rest of the network.

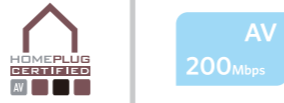
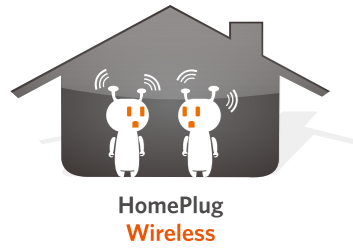

Wall-mount HomePlug Wireless

- AV Wireless N Access Point PS827-AP



PS827-AP

AV Wireless N Access Point

- Qualcomm Atheros AR6400 or AR6405 chipset
- Create or extend a wireless network by using HomePlug Powerline technology as the network backbone
- Integrated and external antenna options
- Optimized for HD/SD cable, satellite and IPTV installations, Home multimedia content and storage, multi-room DVR networking, online/networked console and PC video game connections, and much more
- Compatible with 802.11n Draft 2.0 specifications providing wireless speed up to 300Mbps data rate. Also compatible with IEEE802.11g high rate standard providing wireless speed up to 54Mbps data rate
- WEP/WPA wireless security
- 128-bit AES security
- CSMA/CA, TDMA
- QoS
- 2-28Mhz

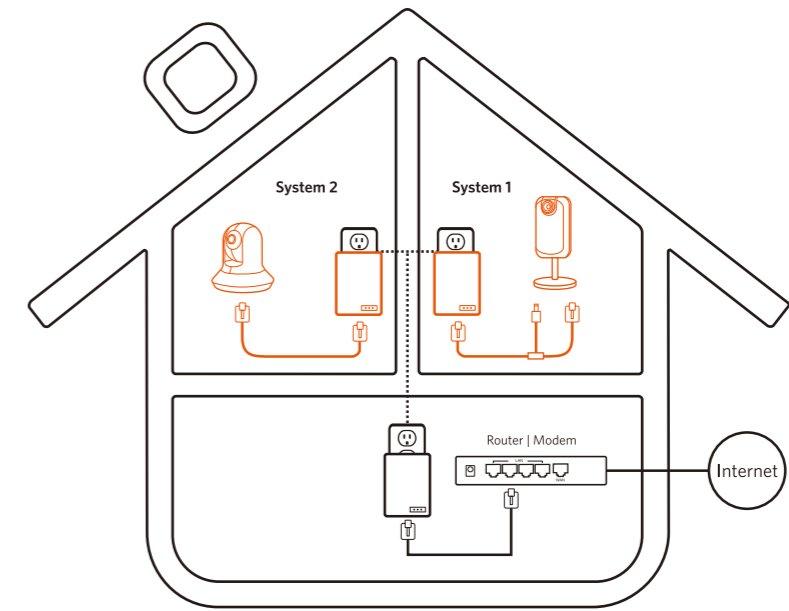

HomePlug Security Surveillance System Usage Diagram

HomePlug Security Surveillance System 1 is a **AV Ethernet Power Supply + IP Camera Surveillance System**. The IP Camera in this system is one of the smallest and elegant camera in the market today. The video also can be viewed on computers, laptops, and mobile phones over a local area network or the Internet.

HomePlug Security Surveillance System 2 is our **AV PoE + PoE IP Camera Surveillance System**. Every PoE IP camera in this system comes equipped with a HomePlug AV PoE power supply in which the camera receives power and sends digital video signals through the Ethernet cable. The video can be viewed on computers, laptops, and mobile phones over a local area network or the Internet.

HomePlug Security Surveillance System

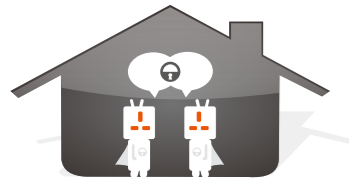

HomePlug
Security Surveillance



AV
200Mbps

HomePlug Security Surveillance System 1	Model Number
○ AV Power over Ethernet + Camera	PE925-PLA+C
HomePlug Security Surveillance System 2	
○ AV Ethernet Power Supply + Camera	PE925-PoE+C

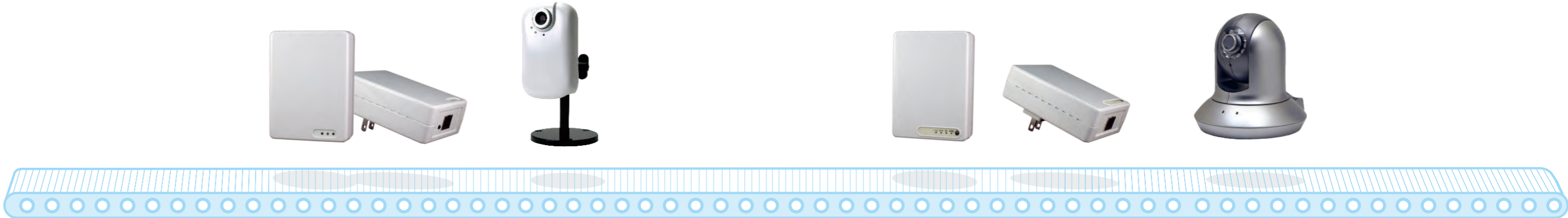

PE925-PLA+C

HomePlug Security Surveillance System 1

AV Ethernet Power Supply

- Qualcomm Atheros AR6400 or AR6405 chipset
- Optimized for HD/SD cable, satellite and IPTV installations, Home multimedia content and storage, multi-room DVR networking, online or networked console and PC video game connections
- Include Y-Cable to provide both data and power
- 5V / 1A, 12V / 0.5A power output levels
- Security push button for software free configuration
- 128-bit AES security
- CSMA/CA, TDMA
- QoS
- 2-28Mhz

IP Camera

- High-sensitivity progressive scan CMOS sensor
- Crystal clear images at 30 frames per second in VGA resolution
- MPEG-4 and Motion JPEG streams can be sent simultaneously from each channel

PE925-PoE+C

HomePlug Security Surveillance System 2

AV Power over Ethernet

- Qualcomm Atheros AR6400 or AR6405 chipset
- Supply DC power to a PoE enabled device with only a RJ45 Ethernet cable
- Optimized to power any PoE enabled device such as: IP cameras, set-top boxes, modem, router, or access point, eliminating the need for an additional power supply
- 1-Port support 48V DC power to PoE powered device
- End-point insert type and compatible with IEEE802.3af
- Per port feeding power: 7 watt (Class II)
- Security push button for software free configuration
- 128-bit AES security
- CSMA/CA, TDMA
- QoS
- 2-28Mhz

Power over Ethernet Camera

- Pan/Tilt CMOS IP Camera with an automatic removable mechanical IR-cut filter
- 12 high power Infrared LEDs to cover video footage from any angle and under any lighting condition
- High-sensitivity progressive scan CMOS sensor
- Delivers crystal clear images at 30 frames per second in VGA resolution

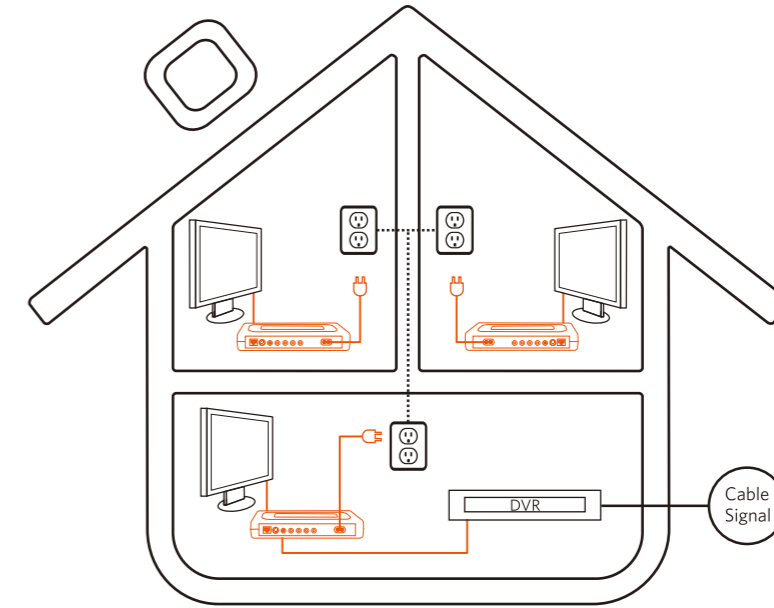

HomePlug Video Usage Diagram

With GigaFast HomePlug Video products, video signals can be distributed throughout the house without pulling any additional wires.

New to our HomePlug Video lineup is the HD Video System. The HD Video System lets users stream HDTV content to everywhere at the home without new wires. The HD Video Receiver can easily be connected to HDTV via HDMI™ cable and eliminates the hassles of in-wall wiring while AV equipment is connected directly to the Transmitter. It also lets users stream from a HD video camera to a remote site for monitoring or recording. The HD Video System consists of 1 Transmitter and 1 Receiver, delivering HD video and audio from the users' AV equipment, such as Blu-ray Disc™ players or gaming consoles, to compatible HDTV display.

Our SD Video System connects via S-Video or Composite jacks to any TV or video recorder system such as a VCR or DVR.

HomePlug Video

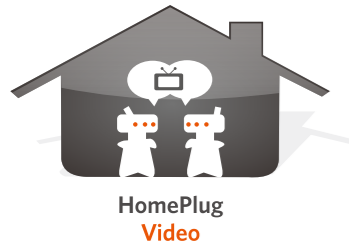

AV
500Mbps



AV
200Mbps

NEW



AV HD Video System	Model Number
○ AV HD Video Transmit Node	PE885-TX
○ AV HD Video Receive Node	PE885-RX

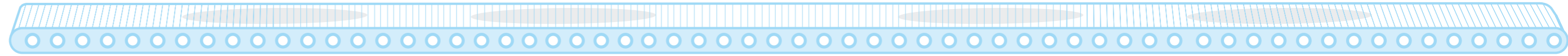

HomePlug AV HD 500Mbps Video System

PE885-TX2

AV HD 500Mbps Video Transmit Node

- Qualcomm Atheros AR7420 chipset
- Supports up to 1920 x 1080 @ 60i or 1920 x 1080 @ 24p input sources
- H.264 compression technology
- MPEG-1 layer II stereo audio supported, optional 5.1 channel for AC-3 and AAC
- One transmitter works with multiple receivers
- Back channel to support remote IR control
- Supports HDMI and HDCP v1.1
- Optional interfaces: HDMI v1.3, HDCP v1.2, YPbPr, S/PDIF, RCA audio
- 128-bit AES security
- CSMA/CA, TDMA
- QoS
- 2-28Mhz

PE885-RX2

AV HD 500Mbps Video Receive Node

- Qualcomm Atheros AR7420 chipset
- Supports up to 1920 x 1080 @ 60i or 1920 x 1080 @ 24p input sources
- H.264 compression technology
- MPEG-1 layer II stereo audio supported, optional 5.1 channel for AC-3 and AAC
- One transmitter works with multiple receivers
- Back channel to support remote IR control
- Supports HDMI and HDCP v1.1
- Optional interfaces: HDMI v1.3, HDCP v1.2, YPbPr, S/PDIF, RCA audio
- 128-bit AES security
- CSMA/CA, TDMA
- QoS
- 2-28Mhz

HomePlug AV HD Video System

PE885-TX

AV HD Video Transmit Node

- Broadcom BCM60321 chipset
- Supports up to 1920 x 1080 @ 60i or 1920 x 1080 @ 24p input sources
- H.264 compression technology
- MPEG-1 layer II stereo audio supported, optional 5.1 channel for AC-3 and AAC
- One transmitter works with multiple receivers
- Back channel to support remote IR control
- Supports HDMI and HDCP v1.1
- Optional interfaces: HDMI v1.3, HDCP v1.2, YPbPr, S/PDIF, RCA audio
- 128-bit AES security
- CSMA/CA, TDMA
- QoS
- 2-28Mhz

PE885-RX

AV HD Video Receive Node

- Broadcom BCM60321 chipset
- Supports up to 1920 x 1080 @ 60i or 1920 x 1080 @ 24p input sources
- H.264 compression technology
- MPEG-1 layer II stereo audio supported, optional 5.1 channel for AC-3 and AAC
- One transmitter works with multiple receivers
- Back channel to support remote IR control
- Supports HDMI and HDCP v1.1
- Optional interfaces: HDMI v1.3, HDCP v1.2, YPbPr, S/PDIF, RCA audio
- 128-bit AES security
- CSMA/CA, TDMA
- QoS
- 2-28Mhz